



IMPORTANT EPIRB UPDATE

DATE: JANUARY 9 2014
EFFECTIVE: IMMEDIATELY

GPS ENABLED EPIRBs REMOVED FROM PRECAUTIONARY SAFETY ALERT LISTING

BACKGROUND

Standard Communications Pty Ltd designs and manufactures a range of Emergency Position Indicating Radio Beacons (EPIRBs) that are marketed globally under the GME brand.

On November 4, 2013 Standard Communications Pty Ltd issued a voluntary Precautionary Safety Alert concerning a situation where a small percentage of MT4XX series EPIRBs had failed the self test procedure.

ONGOING INVESTIGATION

Subsequent testing, analysis, plus a detailed review of quality and reliability statistics has shown the incidence of microprocessor malfunction in GME's GPS enabled EPIRBs to be zero.

Consequently Standard Communications Pty Ltd is immediately removing models MT403G, MT403FG and MT406G from the original safety alert (November 4 2013).

Whilst the number of standard (non-GPS) GME EPIRBs reported as 'failed' during the prescribed testing remains exceedingly low, the voluntary safety alert remains in place for these EPIRBs manufactured between January 2005 and June 2010.

MODELS IMPACTED

MT400, MT401, MT401FF, MT403, MT403FF

Date and year of manufacture can be identified from the serial number of the EPIRB.

January 2005 serial numbers commence with **501XXXXX**, and June 2010 commence with **1006XXXXXX**

GME, as do all the major EPIRB manufacturers, continues to recommend that all EPIRBs be tested at regular intervals, approximately once a month or prior to an extended voyage.

Standard Communications Pty Ltd will continue to update both maritime authorities and GME EPIRB customers on the progress of this investigation.

EPIRB TEST PROCEDURE

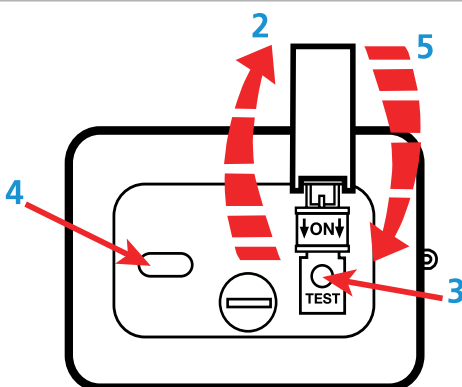

1. Remove the beacon from the bracket. Keep the antenna well clear of metallic objects during testing.
2. Lift the cover marked 'LIFT'.
3. Briefly press then release the yellow 'TEST' button.
4. The unit will give a double beep and flash of the strobe light to show it is functioning correctly.
5. Close the switch cover and press firmly into place until it clicks.
6. Return the beacon into the bracket.

Self test instructions are also printed on the beacon's front panels; and detailed in the owner's instruction booklet.

CONTACT INFORMATION

A division of Standard Communications Pty Ltd.
PO Box 96, Winston Hills, NSW 2153, Australia

PHONE: +61 (0)2 8867 6000, FAX: +61 (0)2 8867 6199
www.gme.net.au
mtfail@gme.net.au



EPIRB PRECAUTIONARY SAFETY ALERT

DATE: NOVEMBER 4 2013
EFFECTIVE: IMMEDIATELY

BACKGROUND

Standard Communications Pty Ltd designs and manufactures a range of Emergency Position Indicating Radio Beacons (EPIRBs) that are marketed globally under the GME brand.

As a result of market place feedback Standard Communications Pty Ltd has become aware of a small number of instances where GME EPIRBs have failed the self test procedure. A consequence of such failure may mean the EPIRB will not operate in an emergency situation.

INVESTIGATION

Subsequent testing and investigation in the company's Sydney engineering laboratory, identified a microprocessor malfunction that effectively shuts the beacon down, hence the self test failure.

Detailed analysis has shown that the failures have occurred in EPIRBs manufactured in the 2005 – 2010 period; to date the overall failure rate remains low, never the less as a responsible supplier of safety at sea equipment, Standard Communications Pty Ltd has in consultation with National Maritime Authorities voluntarily elected to publish this precautionary safety alert.

MODELS IMPACTED

GME MT400, GME MT401, GME MT406G, GME MT401FF, GME MT403/G and GME MT403FF/FG

GME EPIRBs manufactured between January 2005 and June 2010 have been identified as being at risk. None the less, **GME strongly recommends that all EPIRBs** are tested at regular intervals (approximately monthly or prior to an extended voyage).

ACTION REQUIRED

Owners of all GME EPIRBs are required to undertake an immediate test of their beacon using the following procedure:

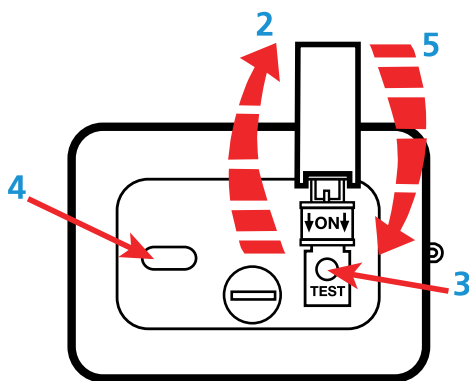

1. Remove the beacon from the bracket. Keep the antenna well clear of metallic objects during testing.
2. Lift the cover marked 'LIFT'.
3. Briefly press then release the yellow 'TEST' button.
4. The unit will give a double beep and flash of the strobe light to show it is functioning correctly.
5. Close the switch cover and press firmly into place until it clicks.
6. Return the beacon into the bracket.

Self test instructions are printed on the beacon's front panel; they are also detailed in the owner's instruction booklet.

In the unlikely event of any beacon tested failing to produce a positive self test result, owners should immediately contact their point of purchase or the GME email hotline of mtfail@gme.net.au

CONTACT INFORMATION

A division of Standard Communications Pty Ltd.
PO Box 96, Winston Hills, NSW 2153, Australia
PHONE: +61 (0)2 8867 6000, **FAX:** +61 (0)2 8867 6199
www.gme.net.au
mtfail@gme.net.au